

## REFERENCES AND NOTES

Ref. No.	A.P.N.	Notes	Ref. No.	A.P.N.	Notes
1	067-183-020	V 84-7	41	067-186-100	Merger 6-14-83
2	067-184-210, 220, 230	SMN 79-43	42	067-186-190	Merger 6-14-83
3	067-184-170	SP 80-23	43	067-186-210	Merger 6-14-83
4	067-184-170	SMN 85-6, cond. apvd 7-11-85, final 2-25-86	44	067-186-260	Merger 6-14-83
5	067-181-010	Merger 6-14-83	45	067-186-270	Merger 6-14-83
6	067-181-020; 067-168-290 ptn	Merger 6-14-83	46	067-185-140, 310	MA-OA 86-122, remerger lot 61 transfered to merger listed in note #27
7	067-181-030; 067-168-290 ptn	Merger 6-14-83		067-186-240, 250	(Note: each legal) :! Note: NOT so due to Witt/Abernathy.
8	067-181-040, 050; 067-168-160	Merger 6-14-83	47	067-181-040, 050; 067-168-160	V 88-70
9	067-182-100; 067-185-010	Merger 6-14-83	48	067-181-040, 050; 067-168-160	MA-OA 89-29
10	067-183-010	Merger 6-14-83	49	067-185-140; 067-186-240	NM 89-3
11	067-183-020	Merger 6-14-83	50	067-186-270; 067-122-030	MA-OA 90-36
12	067-183-050	Merger 6-14-83	51	067-185-310	ARX 90-17
13	067-183-080	Merger 6-14-83	52	067-184-130, 140	MIS 91-0002, merged as one parcel, 5-7-91, see #54
14	067-184-030	Merger 6-14-83		067-185-080, 090, 100	
15	067-184-040	Merger 6-14-83	53	067-181-060; 067-168-290	ARC 91-0017, MNA 91-0091
16	067-184-050	Merger 6-14-83	54	067-184-240	MIS 91-0004, merged as one parcel 12-4-91
17	067-184-090, 100, 110	Merger 6-14-83		067-185-210, 220, 320	
<del>18</del>	067-184-130, 140	Merger 6-14-83, see #54	55	067-185-140	MNA 96-0049, lots 57 thru 61, 72 thru 76 (BLK 7)
19	067-184-150, 160	Merger 6-14-83		067-186-240, 250 ptn	lots 60 thru 66 (BLK 14) 9-07-89
20	067-184-230	Merger 6-14-83	56	067-185-310; 067-186-250 ptn	Lot 67 (BLK 14) 9-07-89
21	067-185-020	Merger 6-14-83		067-185-140,310; 067-186-250,240	COC. PLN 2013-00211 Rec.6-18-14 Doc# 2013-091597
22	067-185-030	Merger 6-14-83		067-185-300,310; 067-186-240,250	LLA. PLN 2013-00211 Rec. 6-19-14 Doc# 2013-139807
23	067-185-070	Merger 6-14-83			
<del>24</del>	067-185-080, 090, 100	Merger 6-14-83, see #54			
25	067-185-110	Merger 6-14-83			
26	067-185-130	Merger 6-14-83			
<del>27</del>	067-185-140 ptn	Merger 6-14-83, lots 57 thru 60, 72 thru 76 (BLK. 7)			
	067-186-240, 250 ptn	lots 60 thru 64 (BLK-14), see remerger note #46			
28	067-185-170	Merger 6-14-83			
29	067-185-180, 190	Merger 6-14-83			
30	067-185-200	Merger 6-14-83			
<del>31</del>	067-185-210	Merger 6-14-83, see #54			
32	067-185-230	Merger 6-14-83			
33	067-185-240	Merger 6-14-83			
34	067-185-250 thru 290	Merger 6-14-83			
35	067-185-300	Merger 6-14-83			
<del>36</del>	067-185-310, 140 ptn	Merger 6-14-83, lot 61 BLK. 7 lots 65, 66, 67 (BLK. 14)			
	067-186-250 ptn	see remerger #46			
37	067-186-030, 040	Merger 6-14-83			
38	067-186-050	Merger 6-14-83			
39	067-186-070	Merger 6-14-83			
40	067-186-090	Merger 6-14-83			



Book-67,  
pg. 28

SC

CN

67-18

Book-67,  
pg. 16

Book-67,  
pg. 19

Book-67,  
pg. 17

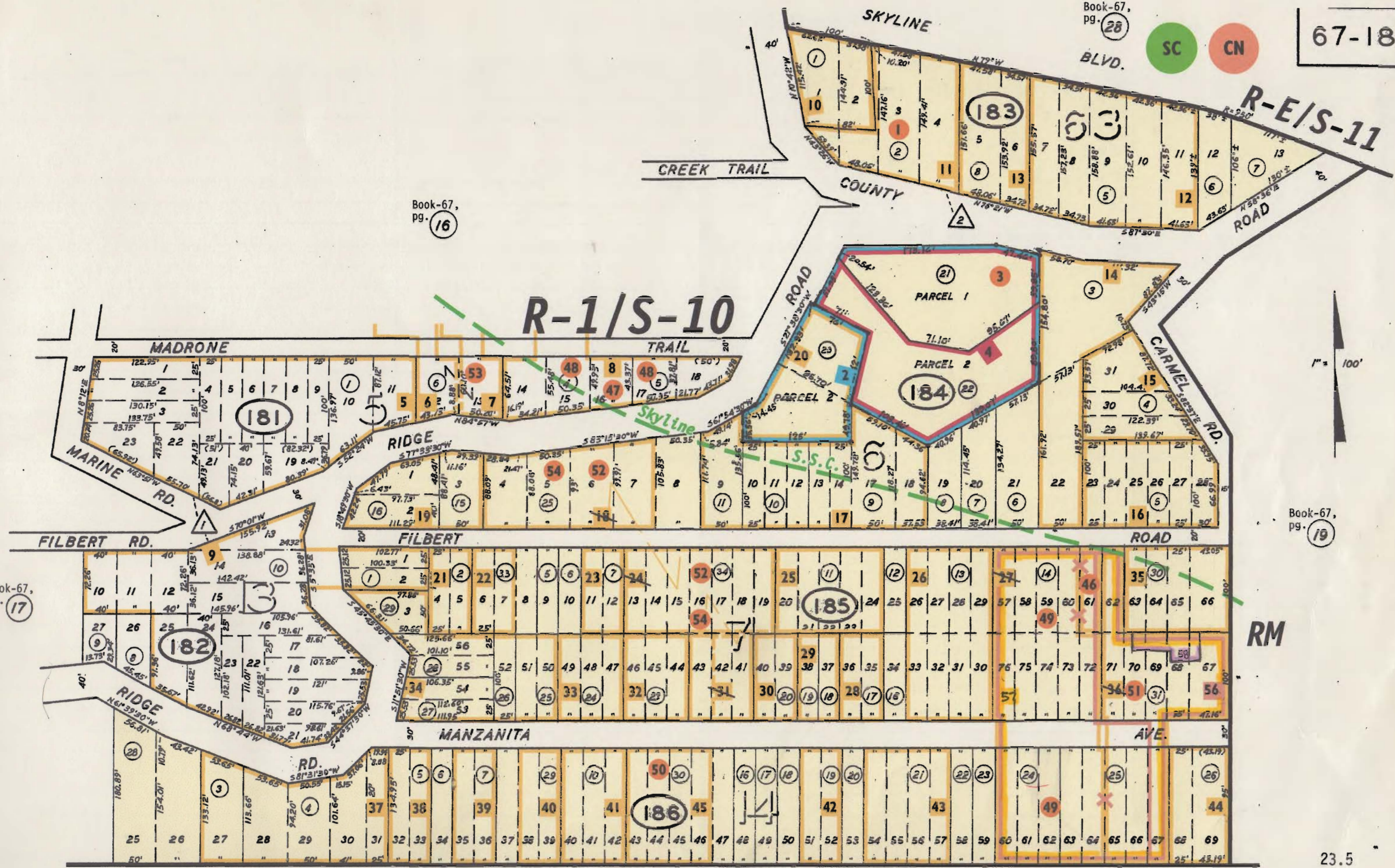

NOTE: RSM OUT OF SCALE

TPZ

Book-67,  
pg. 19

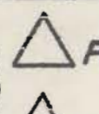

PARCEL MAP VOL 49/80



PARCEL MAP VOL 56/93

ASSESSOR'S MAP COUNTY OF SAN MATEO CA.



REDWOOD PARK NO. 1 RSM 6/46



REDWOOD PARK NO. 3 & RESUB. BLKS. 6 7 & 14  
IN SUB. 1 RSM 6/52

8-77