

REFERENCES AND NOTES

Ref. No.	APN.	Notes	Ref. No.	APN.	Notes
1	037-141-010	CDP 84-30	43	037-141-020, 030	LLA; PLN2017-00301; Doc# 2017-109246; Rec: 12-6-17 (This superceeds XE484 - noted above)
2	037-141-040, 120	MA-OA 83-126			
3	037-142-040	CDP 85-27	44	037-145-020	COC; PLN2015-00021; Doc# 2017-103421; Rec: 11-21-17
4	037-143-120	UP 34-77			
5	037-14 Etheldore	To be widened to 60ft			
6	037-144-010	Var 612			
7	037-144-280	MA-OA 85-71			
8	037-145-390, 400	X6E 368			
9	037-145-070	Var 1628			
10	037-145-070	Var 1659			
11	037-145-200, 320	X6E 346, Lots 29, 30, 31, 30split			
12	037-145-280, 290	X6E 2659			
13	037-145-280, 290	Var 1167			
14	037-145-400; 037-157-090	X6E 3047			
15	037-146-210, 240, 260	UP 2315			
16	037-146-270	Var 1675			
17	037-147-010	V 85-32			
18	037-147-030, 090	X6E 484 (See #43 below)			
19	037-147-030	Var 1236			
20	037-147-070	V 85-26			
21	037-144-290	CDP 86-85, OSP 86-16			
22	037-144-090	MA-OA 87-37			
23	037-142-040, 050	MA-OA 87-43			
24	037-147-070	V 87-69			
25	037-142-040, 050	GPA 88-2			
26	037-146-280	V 88-103			
27	037-145-400	V 89-16			
28	037-144-240	MA-OA 89-119			
29	037-143-050	MA-OA 90-25			
30	037-141-080	V 90-30			
31	037-144-280	DSR 90-24, CDP 90-43			
32	037-146-290	V 91-75			
33	037-144-260	V 91-100			
34	037-147-130; 037-073-120	LLA 91-0013			
35	037-146-280, 290	LLA 92-0018, recorded 7-7-93			
36	037-144-180	Merger, PLN 2000-00764, 1-5-01			
37	037-145-240	Merger, PLN 2001-00737, 1-17-02			
38	037-147-030	COC. PLN 2014-00085 Rec. 6-18-2014 Doc#2014-052675			
39	037-144-030	COC/B & CDP; PLN2014-00171; Rec: 6-19-14			
40	037-144-050, 060, 250	COC/B; PLN2015-00359; Doc# 2016-075322; Rec: 8-2-16			
41	037-141-110, 120	COC; PLN2016-00350; Doc# 2016-116803; Rec: 11-7-16			
42	037-141-100	COC; PLN2016-00352; Doc# 2017-019759; Rec: 2-2-17			

Book-37
pg. 6

- CN
- CZ
APJ
- SH
- HZ
- SF
EX
- ALUC
- AG
EX

37-14

MOSS BEACH HEIGHTS

ALL CD

Book-37
pg. 13

C-1/S-3/DR

PUD/121/DR

R-1/S-17/DR

Book-37
pg. 7

MOSS BEACH HEIGHTS

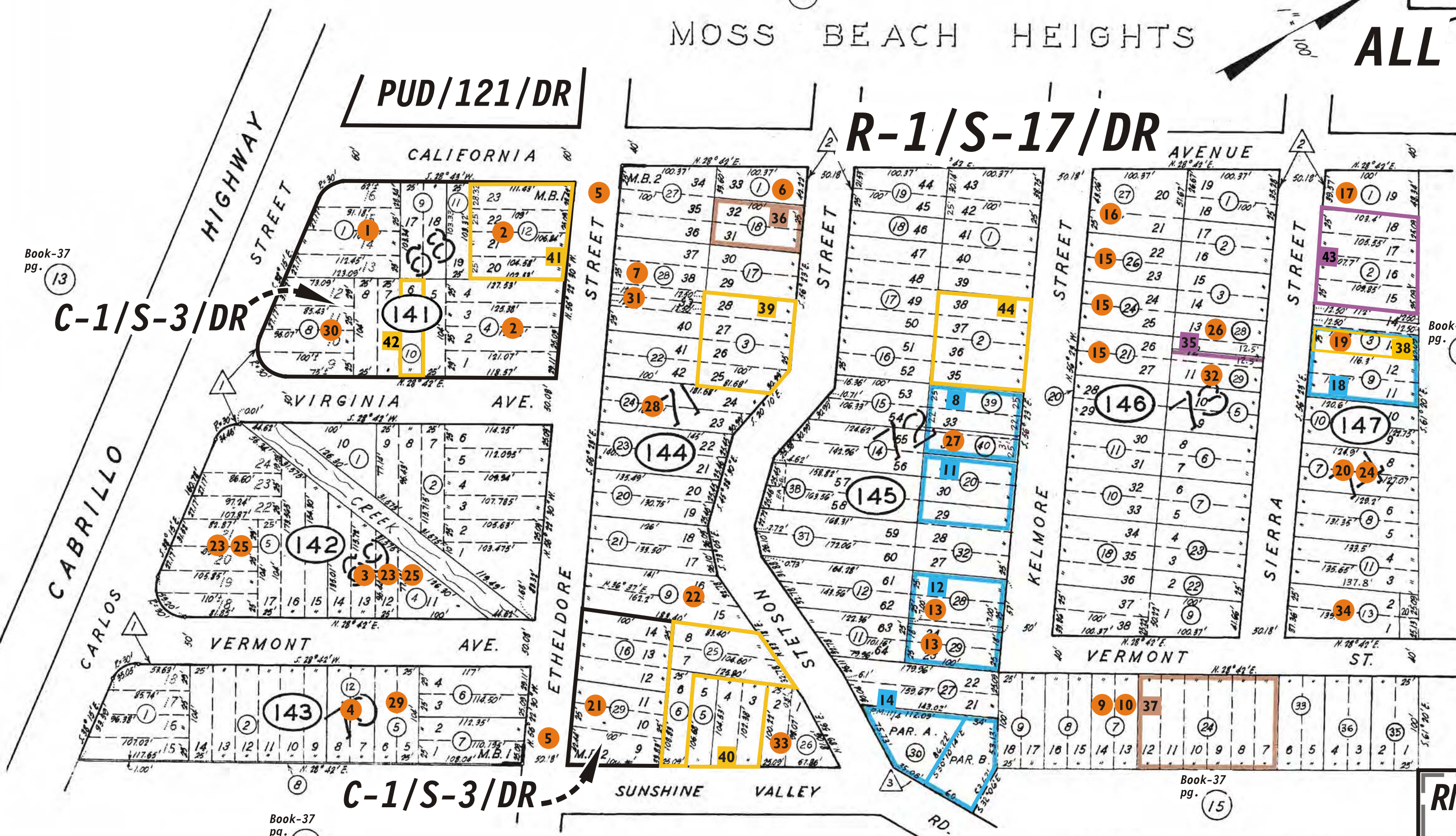

Book-37
pg. 17

Book-37
pg. 15

9.2

RM-CZ

- 3 PARCEL MAP VOL. II/4
- 1 MOSS BEACH ADDITION NO. 1 RSM 6/10
- 2 MOSS BEACH ADDITION NO. 2 RSM 6/11