

REFERENCES AND NOTES

Ref. No.	AP.N.	Notes	Ref. No.	AP.N.	Notes
1	047-021-160, 160	Deleted as per request by Mike Schaller, 7-14-05	39	047-022-010; 048-031-030	MNA 91-0166
2	047-021-120, 130	CDP 82-71	40	047-022-280; 048-091-260	MNA 91-0119
3	047-021-130	UP 15-76	41	047-025-170	MIS 94-0019, 10-14-94
4	047-021-130	UP 48-77	42	047-024-440	USE 92-0013, MIS 94-0018, 10-25-94
5	047-022-020	UP 84-34, CDP 84-58	43	047-021-200	Merger, PLN 2000-00576, 8-17-00
6	047-023-400, 410	CDP 83-16		047-014 blk 19, 20	
7	047-023-420	CDP 81-17, merged 11-6-00 PLN #?	44	047-022-330	Merger, PLN 2000-00773, 3-07-01
8	047-023-420	CDP 82-30, " " "	45	047-023-430	Merger, PLN 2003-00600, 11-20-03
9	047-023-420	Var 1250 " " "	46	047-021-100	COC (Type A), PLN 2011-00376, Doc. # 2012-010171 CONF, 1-26-12 CC
10	047-024-110, 120, 130, 450-480	CDP 83-45, UP 83-22	47	047-021-150	COC; PLN2016-00083; Doc# 2016-027883; 3/30/16
11	047-025-170	SMN 77-65, supeceded	48	047-023-320	COC; PLN2016-00487; Doc# 2016-127622; 12/5/16
12	047-025-170	UP 8-79			
13	047-025-170	Rezoning application 4/77			
14	047-025-170	GP 81-2 (File no longer available)			
15	047-02	Street to be widened to 60 feet			
16	047-022-320	V 86-68			
17	047-023-350	CDP 85-104, Lots 9, 10, 34			
18	047-022-170	V 86-69			
19	047-023-320	V 86-70			
20	047-023-010, 440	V 86-73			
21	047-022-120, 130	CDO 86-91			
22	047-021-190	CDP 87-16			
23	047-022-070	CDP 87-20			
24	047-024-240	VA 87-4, CDP 87-22			
25	047-021-190	UP 87-10			
26	047-022-330	MA-OA 88-4			
27	047-023-420	CDP 88-40, merged 11-6-00, PLN #?			
28	047-023-190, 200	UP 88-13, CDP 88-63			
29	047-021-170, 180	LLA 88-21, final 11-16-88, CDP 88-57			
30	047-022-090, 100	CDP 88-91			
31	047-024-150	MA-OA 89-122			
32	047-024-090, 150	DSR 90-55, CDP 90-82			
33	047-023-020	V 90-290			
34	047-02, all Princeton	ZR 89-2, 3-21-91			
35	047-022-060	MNA 91-0054			
36	047-023-080, 300	CDP 91-0048, USE 91-0018, DSR 91-0118			
37	047-023-190, 200	USE 91-0030, CDP 91-0068			
38	047-022-270	MNA 91-0114			
	047-021-030				

Book-47
pg. 1

TAX CODE AREA

34
47-2

ALL CD

- CZ APJ
- SH
- HZ
- SC
- ALUC
- FH

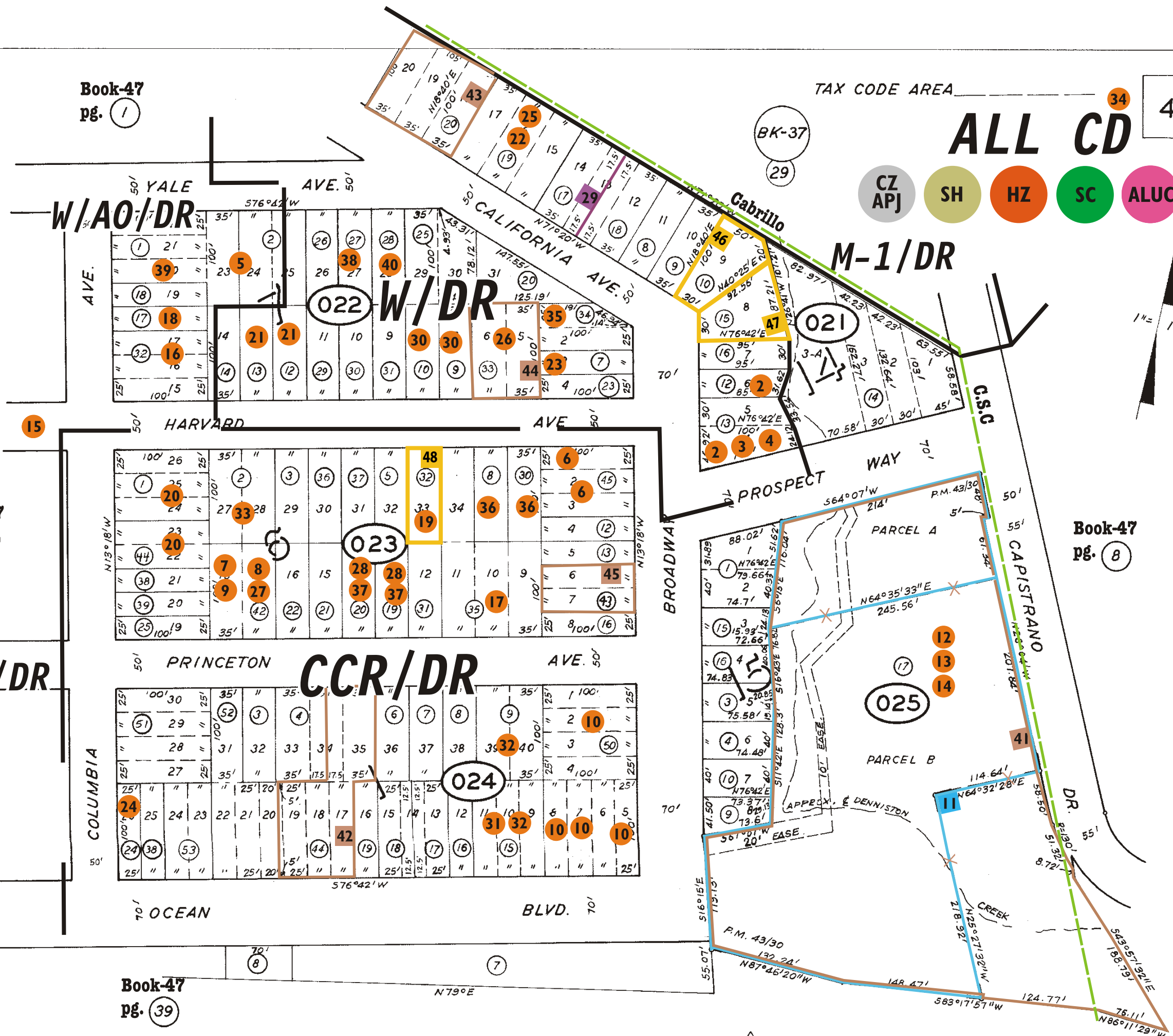

Book-47
pg. 3

Book-47
pg. 8

Book-47
pg. 39

- △ PRINCETON BY THE SEA RSM 6/32
- △ PARCEL MAP VOL. 43/30-31