

REFERENCES AND NOTES

Ref. No.	A.P.N.	Notes	Ref. No.	A.P.N.	Notes
1	047-330-010	SP 80-15			
2	047-330-020	UP 1492			
3	047-330-040	UP 15-77, UP 14-78 & UP 81-3			
4	047-330-040	CDP 86-88			
5	047-330-010	CDP 87-104			
6	047-330-020	CDP 88-49			
7	047-330-010	V88-66			
8	047-330-040	MA-0A 88-66			
9	047-330-040	CDP 89-43, UP 14-78, RMD 89-7			
10	047-330-010	V90-136			
11	047-330-010	MA-0A 90-99			
	047-331-010				
12	047-330-020	CDP 90-71			
13	047-330-010	CP 90-1			
	047-331-010				
14	047-331-040	SNC91-0001			
	047-261-030				
15	047-330-010	25' of Cortez Ave. remains part of these parcels.			
	047-340-280	Never dedicated per P. Bentley, D.P.W.			
16	047-331-010 parcel 1	PLN 2000-00558, COC type A, 11-2-2000. Drawn approx.			
17	047-331-010 parcel 2	" "			
18	047-330-010 parcel 3	" "			
19	047-331-010 parcel 4	" "			

See Miramar Beach Flood Map on the back of this binder.

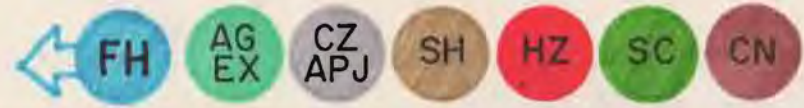

ALL CD 47-33

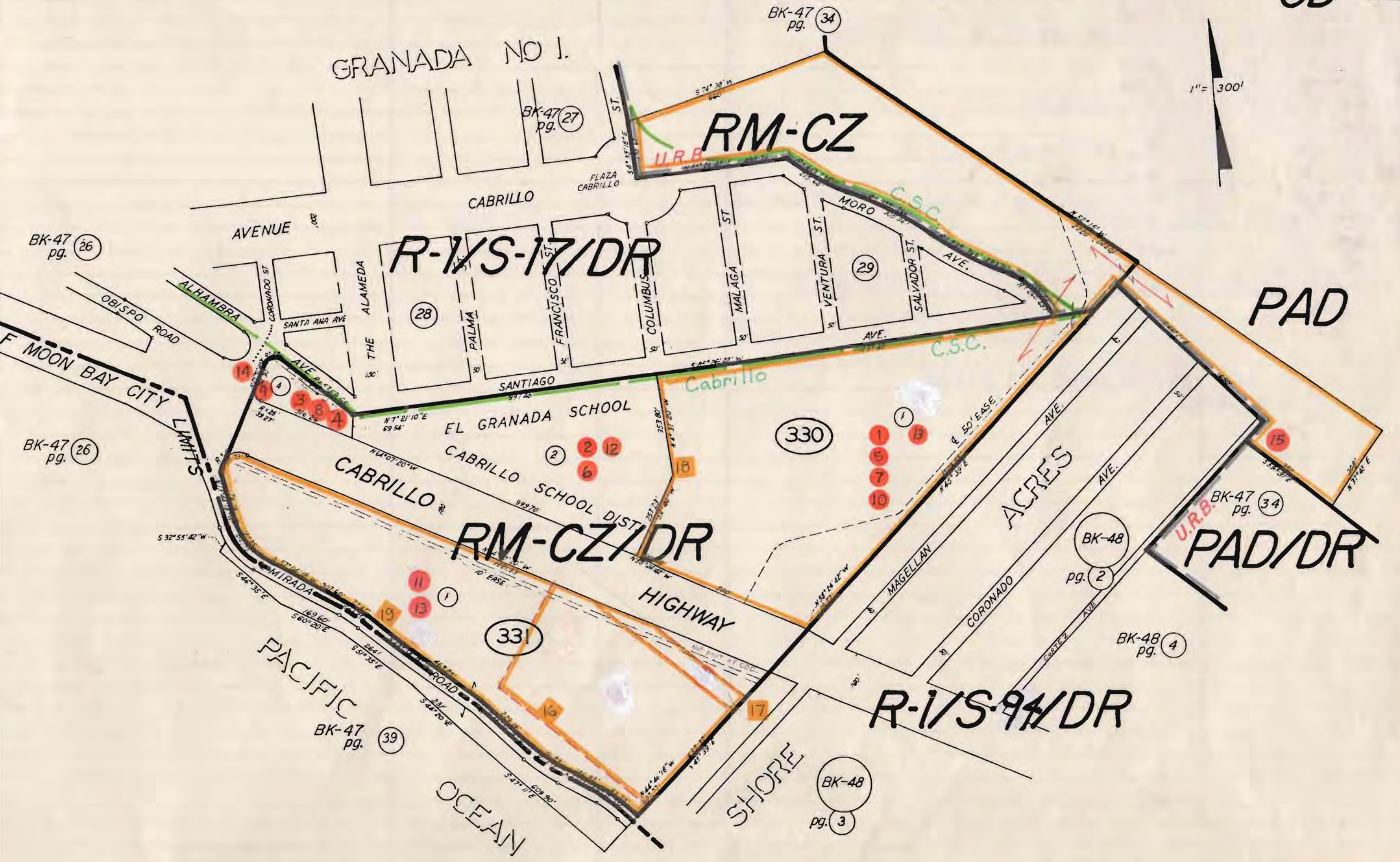

BK-47 pg. 26

BK-47 pg. 26

BK-47 pg. 39

BK-47 pg. 34

BK-47 pg. 27

1" = 300'

330

331

BK-47 pg. 34

BK-48 pg. 2

BK-48 pg. 4

BK-48 pg. 3

16.2
16.5